



FIBRE CEMENT

Installation Guide,
Aftercare and FAQs

CLADCO
DECKING



Cladco Fibre Cement Wall Cladding Boards have been designed to last, manufactured with increased durability.

Each Board is designed to replicate the natural variants of traditional timber cladding. It is recommended to purchase all Boards required for the project at the same time, as this will ensure colour consistency within the batch and a single delivery cost. Please note that the Board colours can have slight variations within each batch, to avoid this it is recommended to buy all the Boards you need at once.

It is recommended to lay out all Cladco Fibre Cement Wall Cladding Boards before installation, to ensure the natural effect of grain, colour and tone is balanced across the whole of your Cladding project.



STORAGE AND HANDLING

Cladco Fibre Cement Wall Cladding Boards should always be stored in a cool, dry, shaded spot, on a flat level surface with the entire Board supported. Ensure Boards are protected from the weather and they are protected from dust, water and debris.

Wet Boards should not be installed as this can result in butt joints shrinking. Cladco Fibre Cement Wall Cladding Boards should always be moved and carried by two physically able people, edge to edge, to prevent the Boards from bending, cracking or splitting. Take Care when handling and moving the Fibre Cement Boards, and avoid bending or arching movements, as this can cause them to shatter.



GUARANTEE

Cladco Fibre Cement Wall Cladding Boards are supplied with a 10-year guarantee subject to terms and conditions. Cladco Fibre Cement Wall Cladding Boards should be installed as per this installation guide. Failure to do so may invalidate the guarantee. For further information, visit www.cladcodecking.co.uk/cladcoprofiles-limited-conditions-sale

TOOLS



Protective Equipment

When handling or carrying Cladco Fibre Cement Wall Cladding Boards, it is advised to wear long sleeves and gloves to protect any exposed skin. When cutting Boards, to protect yourself from the dust a Level P3 Respiratory protective Mask must be worn. Ear defenders and safety glasses are also recommended.



Tool Set

Standard everyday DIY or carpentry tools such as a tape measure, spirit level, pencil and Stanley knife.



Cutting Tools

Low-speed and low-dust cutting tools are recommended, however, a standard circular saw blade with carbide teeth, or a hand-held circular saw with a diamond saw blade, will be able to cut through the material, if necessary.



Staple Gun

Used when fixing the Damp Proof Course material into the Wooden Joists.



Health and Safety

When working with Fibre Cement materials, it is imperative that proper care is taken and necessary precautions are met. When Fibre Cement Boards are cut, fine dust is released into the atmosphere - the mineral itself is harmless, however dangerous if inhaled and will constitute a health hazard. A Level P3 Respiratory Protective Mask should be worn when cutting the Boards.

DO'S & DON'TS



Do not install Fibre Cement Wall Cladding if the Boards, building or the surrounding areas are wet



Do not cut the Fibre Cement Wall Cladding Boards indoors



Do not dry sweep dust or debris off the Boards, as it may cause the particles to enter the air and could be inhaled - wipe away with a damp cloth



Always follow the tool manufacturer's safety recommendations when using saws or other machinery



Nail guns can be used for fixing the Boards

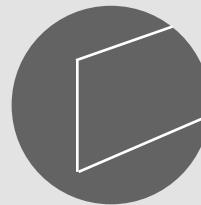

Always carry Fibre Cement Boards horizontally with the help of another physically abled adult

PREPARING THE WALL

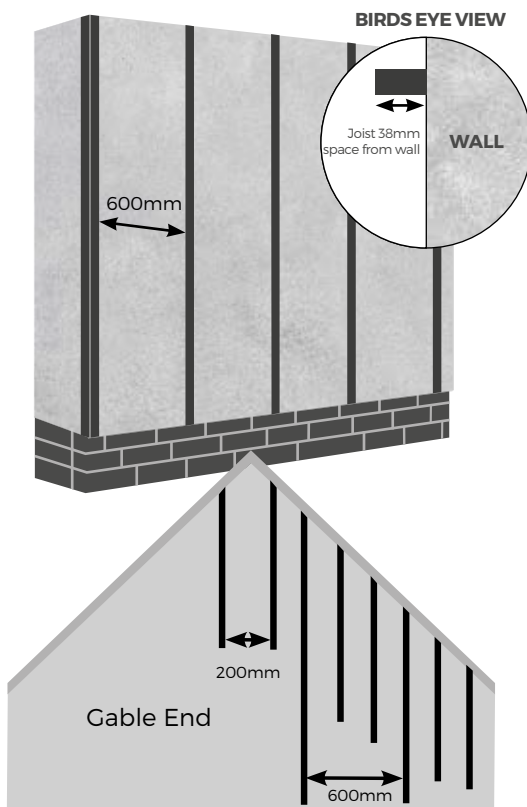

STEP 1: JOISTS

Install the 50mm x 38mm Timber Joists with the 50mm area flush to the wall, creating a 38mm ventilation gap between the wall and the Fibre Cement Cladding Boards.

Joists must be no more than 600mm apart, reducing to 400mm or 500mm at boundary areas, and a clear space of 38mm should be left at the base of the Joists

If your home has a gable end - where the two exterior walls reach up to the roof in a triangular shape, creating a portion of a wall between two intersecting roof pitches - Joists must be installed in a certain way.

Joists must be spaced up to 600mm apart with additional, shorter supporting Joists installed every 200mm between, going up and down the apex (the triangular shape of your gable end). This ensures the Boards are fully supported across the entire build.

Ensure all Joists are vertical and level using either a tape measure or a spirit level before moving on to the Trims and details.

Please note the Damp Proof Course, must be installed on any Joists around corners or on any double Joists (where two Cladding Boards are butted together).

INSTALLATION

STEP 2: CORNER TRIMS AND STARTER STRIP

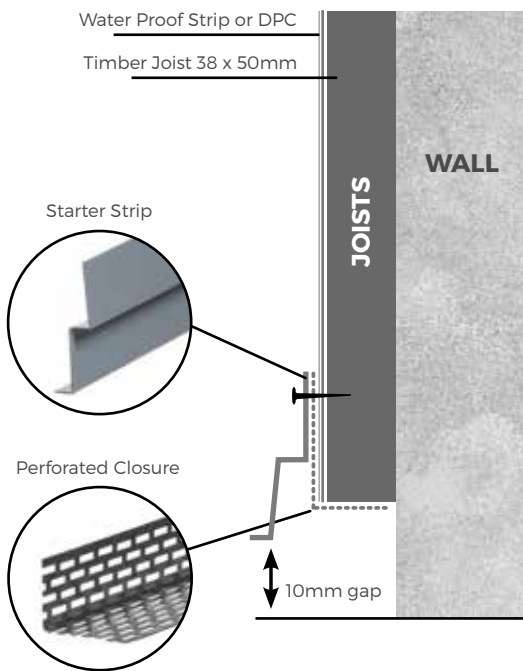

Once the Joists are installed. A Water Proof Strip or DPC (Damp Proof Course) must be fitted to any Joist which will have a Corner Trim attached to it, or boarders any windows or doors. Fix the DPC using a staple gun at regular intervals. Then, at the base of the Joist fit the Perforated Closure with a 40mm Screw.

Screw the Starter Strip to the Joist, as per the diagram, only at the top of the Strip and through both the Joist and the Perforated Closure at the base.

Ensure the Starter Strip is at the correct orientation, with the lip of the Strip just below the base of the Joist. Make sure there is a 10mm clearance between the base of the Strip and the base of the wall.

Corner Trims must be installed before the Cladco Fibre Cement Boards can be fitted to the wall.

Fix the Corner Trims to the Joists, ensuring the Trim overlaps the joist on either side by 10mm. Fix the Trim to the Joist using 40mm Screws, at regular intervals until the Trim is secure.

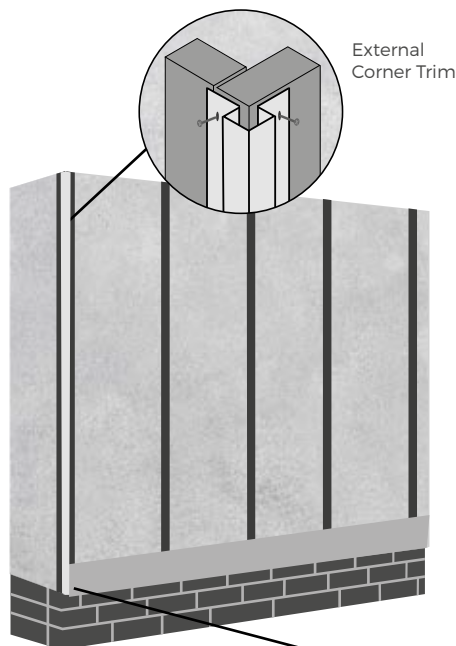

STEP 3: FIXING THE FIRST BOARD

The first Board will be fixed to the side of the building using the attached Starter Strip as a support.

Mark 180mm up from the base of the Starter Strip and ensure it is level. This will be where the top of your first Board will sit.

Fix the Board to the Starter Strip and Joists behind with a 40mm Screw. Screws should always be inserted at the top of the Board into the structural Joists.

There must be a 15mm clearance gap between the edge of the Board and each 40mm Screw.

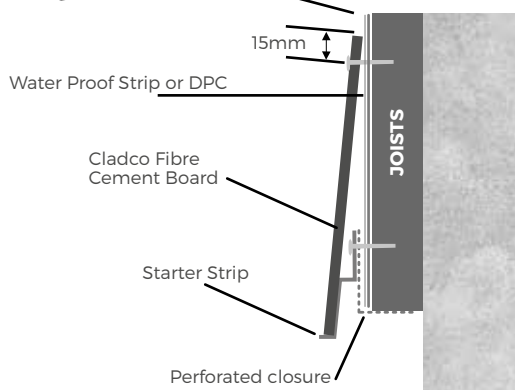

INSTALLATION

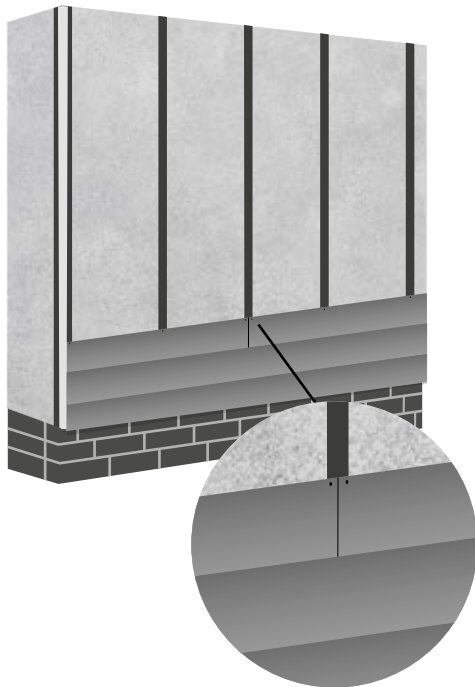
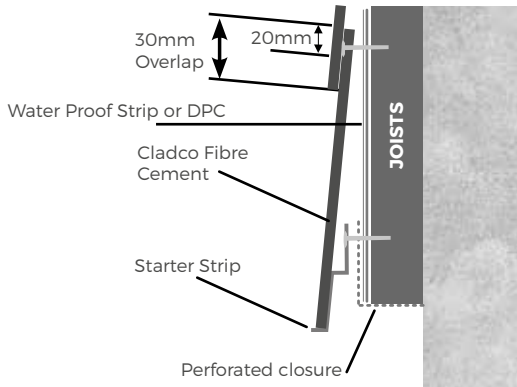

STEP 4: FIXING THE REST OF THE BOARDS

Place your second Cladco Fibre Cement Wall Cladding Board so that the base of the Board overlaps the top of the first Board by a minimum of 30mm. The dimensions of the overlap must be maintained throughout the installation.

Insert the 40mm Screw through the top of the new Cladding Board into the Joist as before.

Once the Board has been secured, measure 180mm from the top of the Board to give the next Boards, top rate edge height. This is to ensure that the correct gaps are being met throughout the installation. Install the rest of the Boards following this method

TOP TIP To ensure coverage of your desired width, the Fibre Cement Wall Cladding Boards may need to be butted together. The Boards can be flushed next to each other with no need for a clearance gap, as the Boards have a minimal expansion and contraction. When two Boards meet, they must be supported by two adjacent Joists behind.

The double Joists must both be fitted with a Damp Proof Course before the Boards are installed.

STEP 5: INSTALLING YOUR LAST BOARD

It is unlikely that Boards will fit exactly to your wall height, and it may be necessary to cut the last Board to the correct width. To ensure the Board is cut correctly, measure the distance from the top of the previous Cladding Board to the top of your wall, ensuring to include the 30mm overlap.

Leave enough space for a 10mm ventilation gap between the Boards and the underside of the soffit.

Once the last Board is cut to size, install exactly as before.

TOP TIP We advise to check the installation with a spirit level every four rows to ensure the angle and level of each Board is maintained throughout.

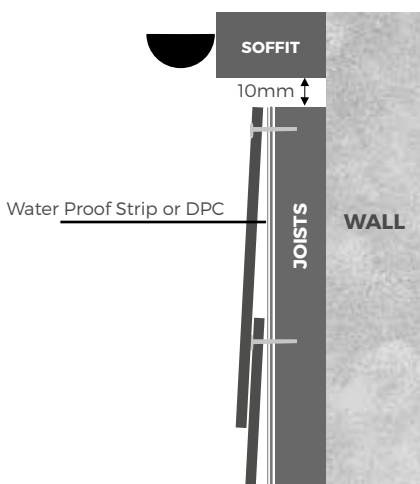

INSTALLATION

FINISHING AROUND DOORS AND WINDOWS

WINDOWS AND DOORS

The Joists above the windows or doors will need to be installed as per Step One with the Perforated Closure and Starter Strip installed to support the Fibre Cement Cladding Boards above the windows or doors.

If Fibre Cement Wall Cladding Boards may need to be trimmed and cut to fit around doors and windows, measure the space needed and cut the Boards to length. Be sure to wear a Level P3 Respiratory Protective Mask when cutting the Boards.

Before the Wall Cladding can be installed around any windows or doors, End Profile Trims must be fixed to the Joists, fitted using 40mm Screws at regular intervals. If your doors, windows or walls require bespoke Trims, these are fitted here instead of the End Profile Trims.

Once installed correctly the Wall Cladding Boards can be fitted onto the End Profile Trims. secure the cut to size Boards using 40mm.

CLADCO ALUMINIUM TRIMS

PERFORATED CLOSURE

Installed under the Joists at the base of the build, or at the top of any doors, and windows, to ensure ventilation throughout the installation. Perforated Closures also protect the build from any dirt or insects penetrating the air flow space.

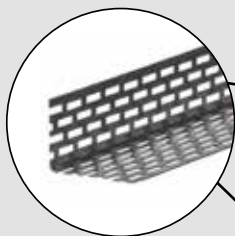

END PROFILE

End Profile Trims are installed around window and door frames.

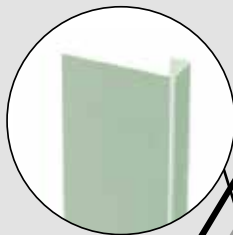

INTERIOR CORNER TRIMS

These are used in the inside of a door frame or porch. Install onto the Joists and the Fibre Cement Wall Cladding Boards by screwing through the flat edge.

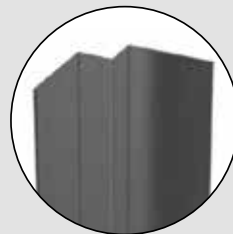

EXTERIOR CORNER TRIMS

Exterior Corner Trims are used on the corners of your build, fitted to the Joists and the Fibre Cement Wall Cladding Boards, and installed by screwing the Boards through the flat edges of the Trims.

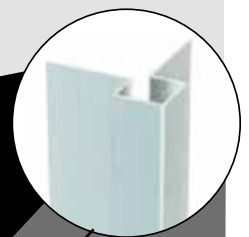

STARTER STRIP

Installed at the base of the build, or above any doors and windows as a support for the initial Fibre Cement Cladding Board to be installed upon.

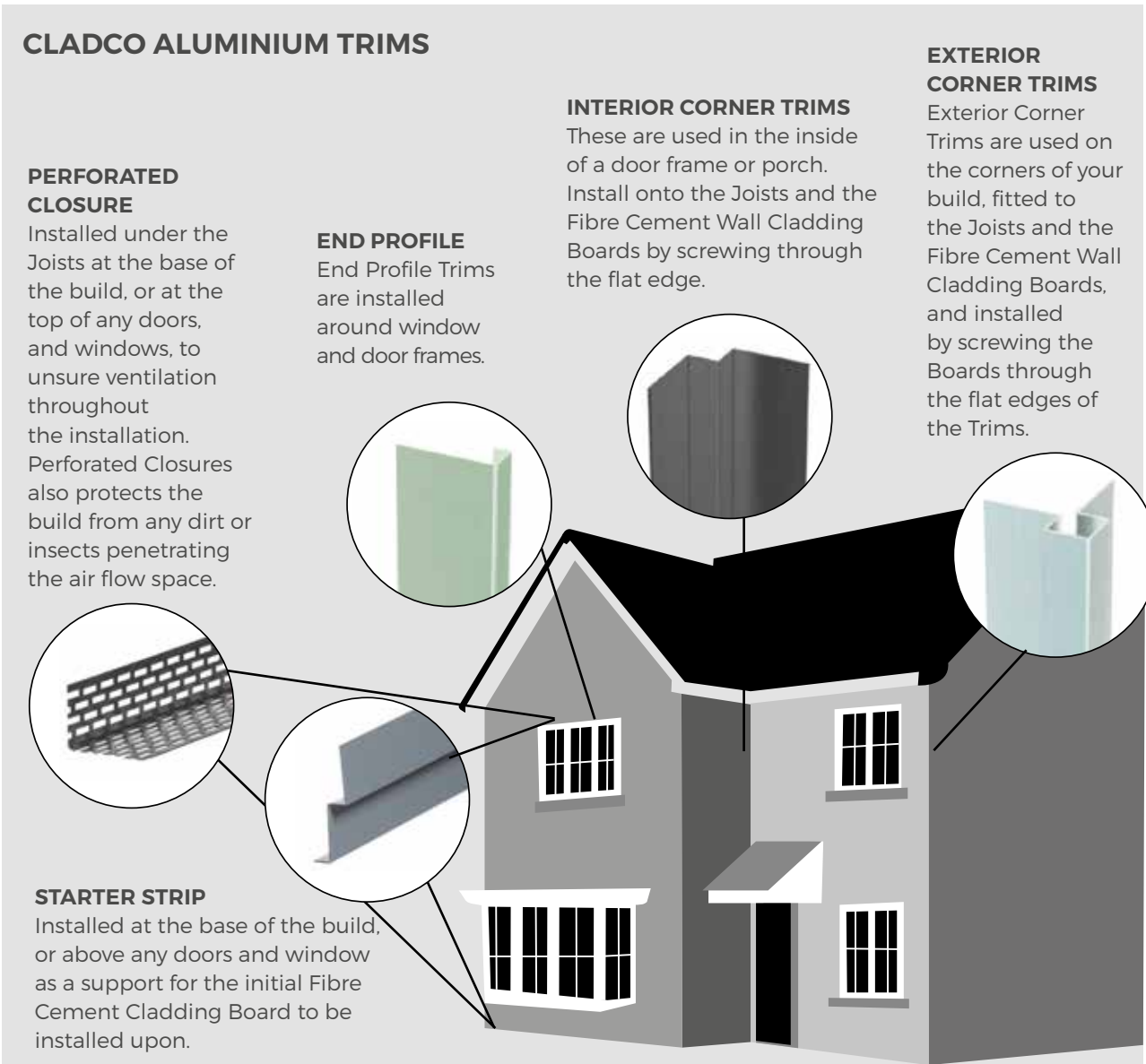
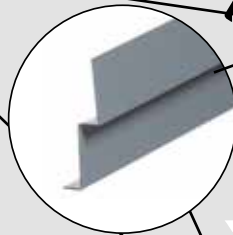

AFTERCARE



MAINTAINING

Ensure your Boards are kept clear of debris and dirt by cleaning with lukewarm or cold water. A mild, household dish soap can be added for more stubborn stains such as bird droppings.

Mildew and algae should not grow on the Boards, thanks to their rot and weatherproof properties. Ensure the Boards are kept clean of dirt, pollution and other stains by checking them annually and giving them a quick clean when necessary.

Cladco Fibre Cement Wall Cladding Boards are painted using a paint-and-bake method to give them their durable properties and unique look. However, the Boards can be painted with any coloured outdoor paint for an alternative colour. If you are wishing to paint the Cladding Boards, it is recommended to purchase the Unpainted Fibre Cement Cladding Board.

Important – Do not use high-pressured cleaning systems on Cladco Fibre Cement Wall Cladding Boards as this may cause damage to the paint and finish of the Boards.

FREQUENTLY ASKED QUESTIONS

Where can I install my Fibre Cement Cladding Boards?

Fibre Cement Wall Cladding Boards can be installed on any interior or exterior surface with the correct support structure garages, sheds, houses, or garden rooms.

Can I use a pressure washer?

Pressure washers are not recommended to be used on Cladco Fibre Cement Wall Cladding Boards as the pressure could strip the Boards of their paint layers and properties.

Simply clean using lukewarm or cold water and light detergent with a cloth or soft brush.

What is dimensionally very stable?

Cladco Fibre Cement Wall Cladding Boards, like any material exposed to sunlight over a prolonged period of time, will get warmer. Like most materials, when Cladco Fibre Cement Wall Cladding Boards change temperature, slight expansion or contraction within the Boards can occur. These changes are minimal compared to alternative products on the market.

Can Cladco Fibre Cement Wall Cladding Boards be installed vertically?

Cladco Fibre Cement Cladding Boards cannot be installed vertically.

The Cladco Fibre Cement Boards are designed to be installed horizontally using a feathering technique, giving your building an attractive finished appearance.

Installing the Boards vertically is not recommended by Cladco Profiles as detailed in Cladco Terms and Conditions.

Can Cladco Fibre Cement Wall Cladding Boards be painted?

Cladco Fibre Cement Wall Cladding have been painted using a paint and bake method which gives the Boards increased durability and strength. Boards can either be painted an alternative colour (if you are doing this, we recommend purchasing the Unpainted Board) and can be touched up if necessary.

Are the Boards scratch resistant?

Cladco Fibre Cement Wall Cladding Boards, thanks to their three layers of baked paint, have increased scratch resistance properties. The baked paint increases the Boards' durability and should not scratch, or mark easily. Boards may still scratch if handled incorrectly.

What colours are available?

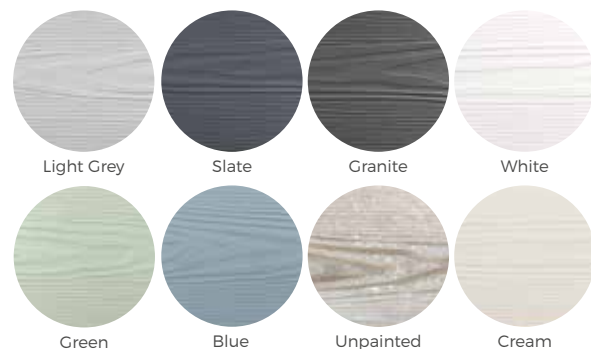

Can I order a Sample?

Cladco Fibre Cement Wall Cladding Samples can be ordered via the website, or by contacting our friendly sales team on 01837 659901.

You can choose two of the eight available colours to sample. The Sample Swatches come with a Cladco Decking Brochure and a Price List.



Choose your two samples



Head Office

Beardown Road
Exeter Road Industrial Estate
Okehampton
Devon
EX20 1UA

01837 659901

info@cladco.co.uk

www.cladcodecking.co.uk

CLADCO
DECKING