

# ASYMMETRIC EXTERNAL CORNER TRIM

## Fibre Cement Lap Trim

Cladco Asymmetric External Corner Trims should protect the corners of your windows and doors while also assisting the fitting of Cladding Boards around these areas. Cladco Asymmetric Trims are designed to be installed on either side of the door or window, allowing for Fibre Cement Lap Wall Cladding Boards to be fitted on the flat surface of the Trim. Cut the Trim to the length or width of the window or door, leaving enough room to accommodate a window sill or step if necessary. Fix to the window or door using the Cladco Fibre Cement 38mm Screw. The window and door Trim will allow one Board to be installed around the front of the window and a single Board around the window or door reveal.

All Cladco Fibre Cement Lap Wall Cladding Trims are available in a range of eight colours, manufactured to match the colour of your Cladco Fibre Cement Lap Wall Cladding Boards for an attractive and seamless design. Trims do not require any staining or painting, and are manufactured onsite using high-quality aluminium for a stain, rust and corrosion resistant product.

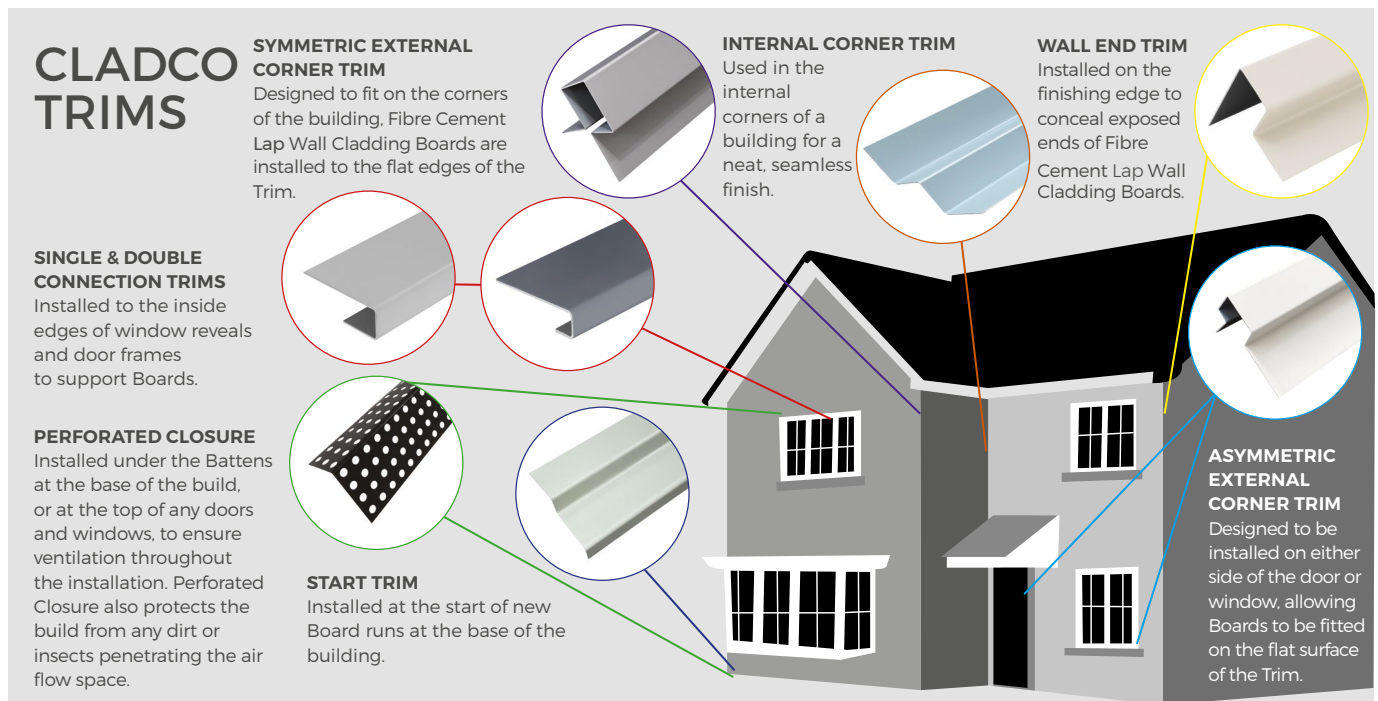
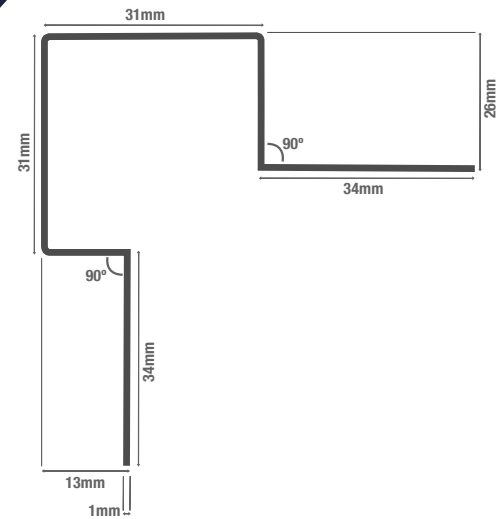

SPECIFICATIONS	
Length	3 metres
Thickness	1mm
Weight (approx)	1.53kg

### COLOURS



**PLEASE NOTE** – Images are used for illustration purposes only, actual item may vary slightly from the image supplied.



01837 659901 [info@cladco.co.uk](mailto:info@cladco.co.uk)  
[www.cladcodecking.co.uk](http://www.cladcodecking.co.uk)

Beardown Road, Exeter Road Industrial Estate, Okehampton EX20 1UA

